

Congratulations on your purchase of the *WhisperGLYDE®* Balance Therapy System. This system was specifically designed and engineered to minimize noise while providing the most efficient trolley movement for the highest quality patient experience and therapy center working environment. Designed to work with *FYZICAL®* balance center *Solostep®* and *Guldmann®* rail systems, the *WhisperGLYDE®* trolley and tether are a direct retrofit. Noise cancelling wheels with soft tyres ensure that the system glides efficiently along the tracks without the harmonic resonance that has been known to elicit complaints from patients and neighboring businesses.

Constructed of aviation grade materials the *WhisperGLYDE®* trolleys also feature low friction bearings and bushings that provide 360 degrees of mobility to patients and durable, trouble free functionality.

*WhisperGLYDE®* is designed to provide your clients with confidence and peace of mind as they receive their therapy, without the distraction of inconsistent movement of the tether and the high ambient noise that could cause them to lose focus; therapy of mind and body.

We appreciate your support and commitment to *WhisperGLYDE Technology®*. Feel free to contact us at +1.941.360.1150 Extension 1, or [info@trixpm.com](mailto:info@trixpm.com) for sales and technical support.

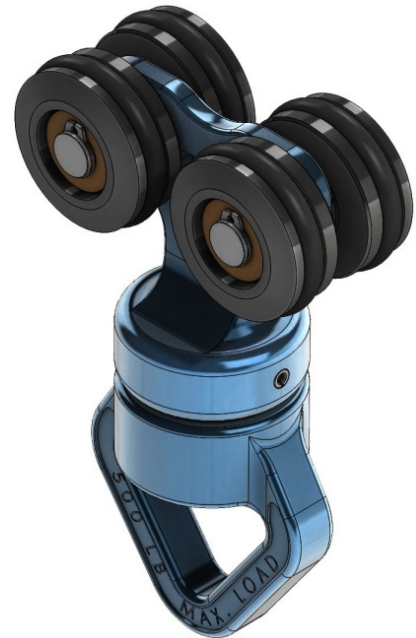

## INSPECTION & MAINTENANCE

- Always read all instructions and warnings contained on the product and packaging before using *WhisperGLYDE®* balance therapy equipment.
- Only use *WhisperGLYDE®* trolleys, tethers and harnesses on approved rail systems: *SoloStep®* or *Guldmann®* for *FYZICAL®*.
- Do not alter or interchange non-matched components.
- Do not disassemble any elements of the *WhisperGLYDE®* trolleys for any reason.
- All balance therapy equipment should be inspected prior to each use.
- This system is not intended to lift the patient; but only to provide support while receiving physical and balance therapy.
- All therapists should be trained in the proper use of balance therapy equipment; including harness application, harness adjustment, tether installation and use.
- Stop using the system if you experience unusual trolley functionality such as intermittent or inconsistent travel and motion. Contact *TRIAx* for technical support.
- Stop using the system if you notice any worn components or looseness in the trolley relative to the rails. Contact *TRIAx* for technical support.
- Follow the recommended installation, inspection and maintenance of the rail system manufacturer.
- Trolleys are "self-braking" under load. They roll freely in normal operation, and do not roll freely when a load is applied.

- Basic care of all safety equipment will prolong the durable life of the unit and will contribute toward the performance of its vital safety function.

## HARNESS & TETHER INSPECTION

- Webbing - Look for frayed edges, broken fibers, pulled stitches, cuts, burns, and chemical damage. Do not use if there is any evidence of damaged or compromised webbing straps.
- Connection Points/Loops - Check for distortion, cracks, tears, broken stitching and/or fraying.
- Attachment of Buckles - Inspect for any unusual wear, cracks, frayed or cut fibers, or breaks in the buckle or attachments.
- Carabiners - Inspect to ensure that carabiners are free of distortion in shape and motion. Ensure that secondary locking mechanism is functioning properly and securely tightened.
- Rope Tether - Rotate the tether while inspecting from end-to-end for any fuzzy, worn, broken or cut fibers. Weakened areas from extreme loads will appear as a noticeable change in original diameter. The rope diameter should be uniform throughout, following a short break-in period.

## CARE & CLEANING

- Keep rails clean of dirt or other forms of contaminants, and follow all care, maintenance and safety recommend-

ations of the rail manufacturer.

- Trolleys and related hardware can be cleaned with a mild solution of soap and water. They are self-lubricated and not intended to be lubricated by the user.
- Nylon or Polyester - Remove all surface dirt with a sponge dampened in plain water. Squeeze the sponge dry. Dip the sponge in a mild solution of water and commercial soap or detergent. Work up a lather with a vigorous back and forth motion; then wipe with a clean cloth. Hang freely to dry, but away from excessive heat.
- Drying - Equipment should air dry thoroughly without close exposure to heat, steam, or long periods of sunlight.

## WARRANTY & SERVICE

- *WhisperGLYDE®* trolleys have a 3 year warranty against any faults in materials or manufacture. Exclusions from the warranty: normal wear and tear, oxidation, modifications or alterations, incorrect storage, poor maintenance, overload, damage due to accidents, damage due to negligence, and damage from uses for which the product was not designed. *TRIAx* is not responsible for the consequences, direct, indirect or accidental, or any other type of damage befalling or resulting from the use of its products.
- Service replacement products are subject to a refundable core charge.
- For warranty or service, contact *TRIAx* at 941-360-1160 or email [info@trixpm.com](mailto:info@trixpm.com).

## WHISPERGLYDE<sup>®</sup> TROLLEY INSTALLATION STEP BY STEP PROCEDURE IN GULDMANN<sup>®</sup> RAILS

### WHAT YOU WILL NEED:

STEP LADDER

5 MM ALLEN (INCLUDED)

PLIERS



**TIME REQUIRED:** APPROXIMATELY 3-8 MINUTES

**DIFFICULTY LEVEL:** SIMPLE



**SAFETY FIRST!** ENSURE THAT YOUR WORK AREA IS CLEAR. FALLING OBJECTS MAY CAUSE INJURIES. ALWAYS HAVE AN ASSISTANT HOLD THE LADDER.

### STEP 1

Locate the rail end spur that has a plastic end cap. It looks like this:



### STEP 2

The plastic cap will simply pop off with a gentle pull.



### **STEP 3**

The exposed rail end looks like this. You will see the safety stop mounted inside the rail. It will be removed temporarily for trolley installation.



### **STEP 5**

Using your 5 MM Allen Wrench, loosen the two (2) bolts on the bottom of the safety stop, but DO NOT remove them. When the safety stop easily slides forward, the bolts are loose enough.



### **STEP 4**

If your safety stop has a small split pin going through the plate and into the rail, using your Pliers - pull the pin out far enough so it is no longer engaged in the rail. You may pull it completely out.



### **STEP 6**

Slide the safety stop towards the open end of the rail.



## **STEP 7**

Remove the safety stop from the rail and place it aside, it will be re-installed.



## **STEP 9**

Slide your trolley(s) down the rail away from the open end of the rail.



## **STEP 8**

Slide your WhisperGLYDE® trolley(s) into the rail.



## **STEP 10**

Almost done! Replace the end stop aligning the split pin with the hole in the rail. Tap the pin back into the rail. Tighten the bolts and replace the end cap. Attach your rope system to the load ring.



**TROLLEY MAXIMUM LOAD RATING – 500 LB**

**DO NOT EXCEED LOAD RATING**

